

How To Install

Detailed installation instructions included with every product.

Lutron dimmers install in minutes. Just 4 easy steps.

1. • Turn power OFF at the breaker panel or fuse box
• Disconnect the wires from the existing switch

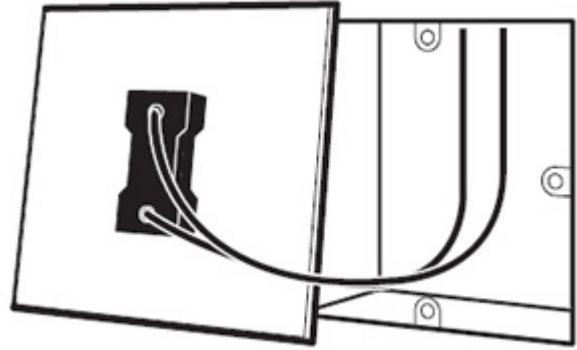

2. • Remove the clip cover and control plate from the switch mounting

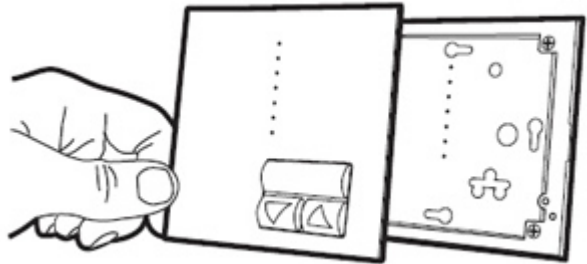

3. • Connect wires to the terminals of the dimmer

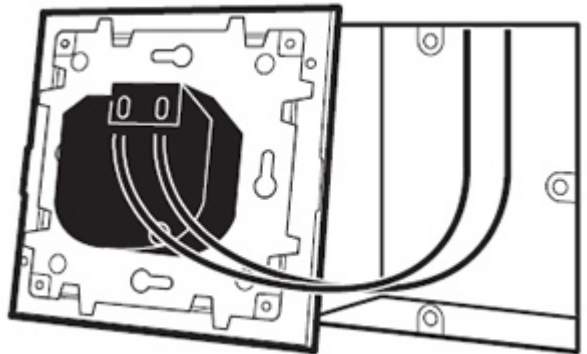

4. • Mount the dimmer and the wallplate
• Turn the power ON at the breaker panel or fuse box

