



The contemporary DRP series user control panels incorporate a revolutionary clip-on cover fastening system which provides the ultimate in aesthetic design flexibility. Incorporating a unique button depth adjustment facility, the panels can accommodate covers of practically any flat architectural surface medium ranging in thicknesses from 1.2mm to 6.5mm. DRP series panels are available in a range of configurations including single column, which provides arrangements of one to eight buttons, and double or triple column designs for up to twenty four buttons. Smooth action buttons with LED indicators provide both tactile and visual feedback and are easily removed for engraving, further assisting the identification of button function. Button backlighting is also provided to illuminate engraved text, improving night time panel location and operation. Infra-red (IR) receive capabilities have been integrated, eliminating the need for separate sensors where IR remote control operation is required.



technical data

Supply

12V DC 20mA from the DyNet network

Control Inputs

1 x RS 485 DyNet serial port

Front Cover Finishes

Standard: Brushed Stainless Steel, White Glass, Black Glass, Processed Stone and Wood Grain. Custom designed and manufactured panels are readily provided incorporating practically any flat architectural finish material.

Button Colours

Charcoal grey or silver. Other colours available upon request.

Compliance

CE, C-Tick

LED Indicators

Status indicator - Blue (standard), Red or Green. Button rear - Red. Other colours available on request.

Operating Environment

0-50°C ambient temperature
0% to 95% RH non condensing

Materials

Grid Plate & Spring Clips - Stainless Steel
PCB Housing & Buttons - ABS
Covers - Stainless Steel, Glass, Processed Stone, ABS.

Weight

Packed weight 0.2kg

standard panel configurations (others available upon request)

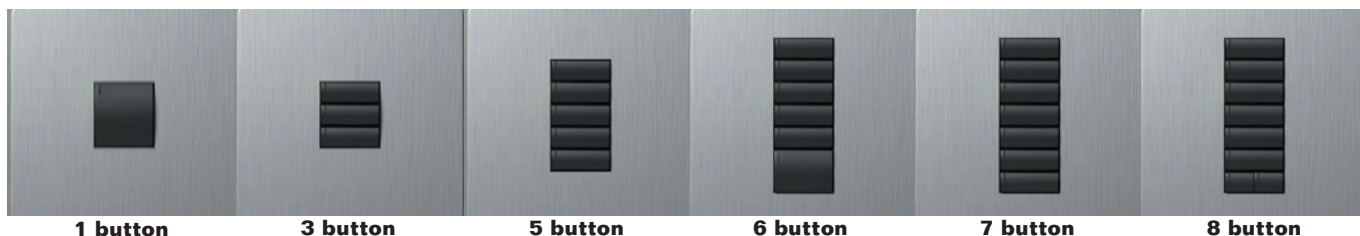

1 button

3 button

5 button

6 button

7 button

8 button

alternate finishes

The Dynalite DRP series user control panels include an extensive designer range of cover and button cap colour accessories. Cover finishes include Brushed Stainless Steel, White Glass, Black Glass, Wood Grain & Processed Stone. To complement these finishes, button caps are available in silver and charcoal grey, providing a wide range of décor matching possibilities. A dedicated IR receive switch cap is also available.

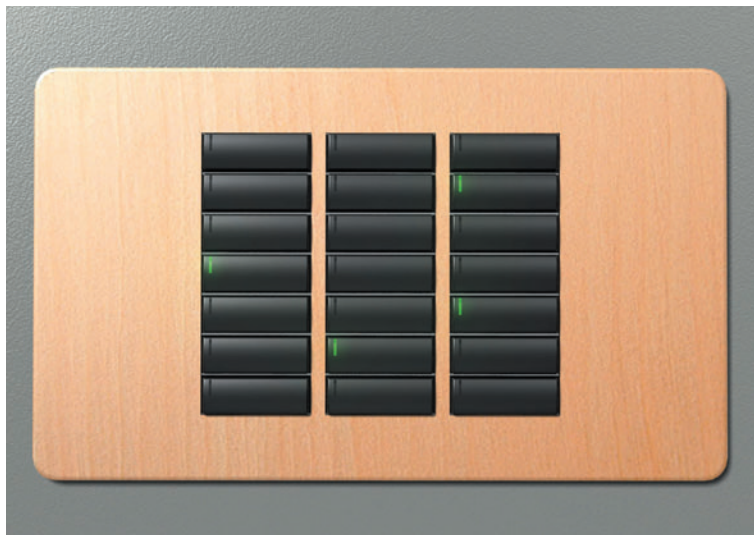
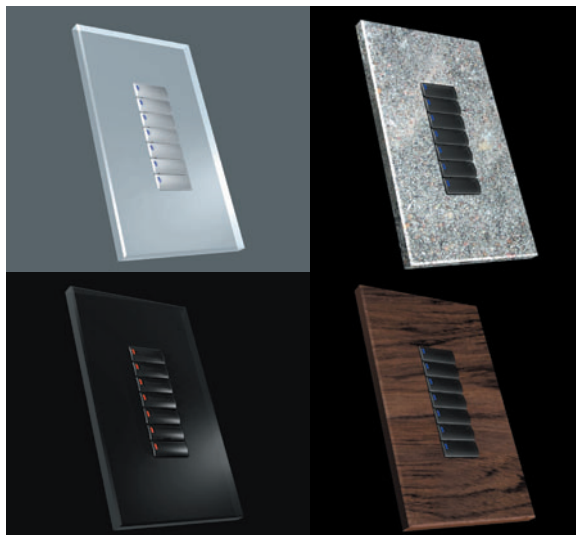

capability

Capability identifies the functionality of the control panel. Dynalite DRP user control panels are available in the new 9 Series Configurable format.

9 Series Configurable	<ul style="list-style-type: none"> Multiple DyNet messages Custom Script Macros Conditional Logic 	One Touch	Preset	Program	Preset Up/Down	IR Input	
		On/Off Toggle	Panic	Multifunction Input Interface	Join (multiple rooms)		

9 Series Configurable

The 9 series configurable panels are an all-purpose solution designed to provide a comprehensive range of control functionality. The advanced intelligence of the 9 series delivers the capability to run sequential and conditional logic routines. 9 series panels can be readily used in demanding applications such as;

- When describing the lighting control functionality using the words 'if' and/or 'then'
- Complex joining of multi-partitioned rooms
- Controlling light scenes in multiple areas
- Interfacing third-party devices to a DyNet network (multifunction input interface)
- In conjunction with smart faders
- Controlling chase sequences
- Infra-red input

dimensions

Single Gang 1 Column

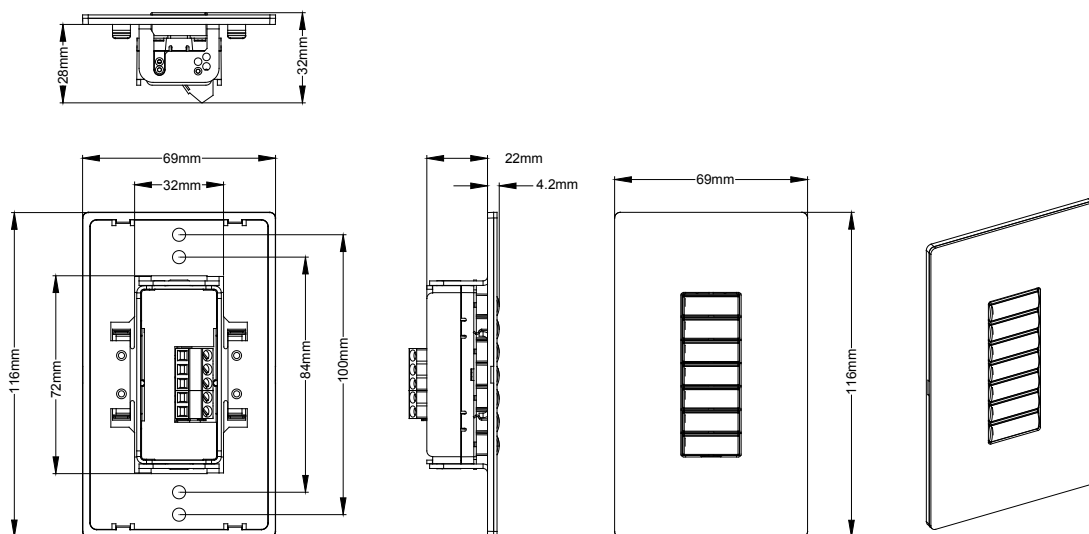

Double Gang 2 Column

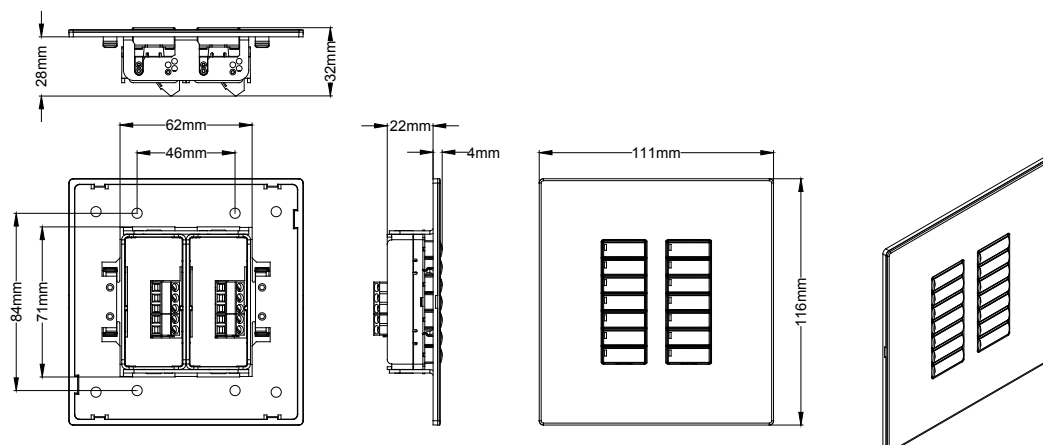

snap-on finish accessories

User requirements can shift over time and necessitate changes to, or additions of, buttons on an existing panel. Buttons and covers clip-on, enabling changes to be easily accommodated, without the need for any tools or extra wiring.

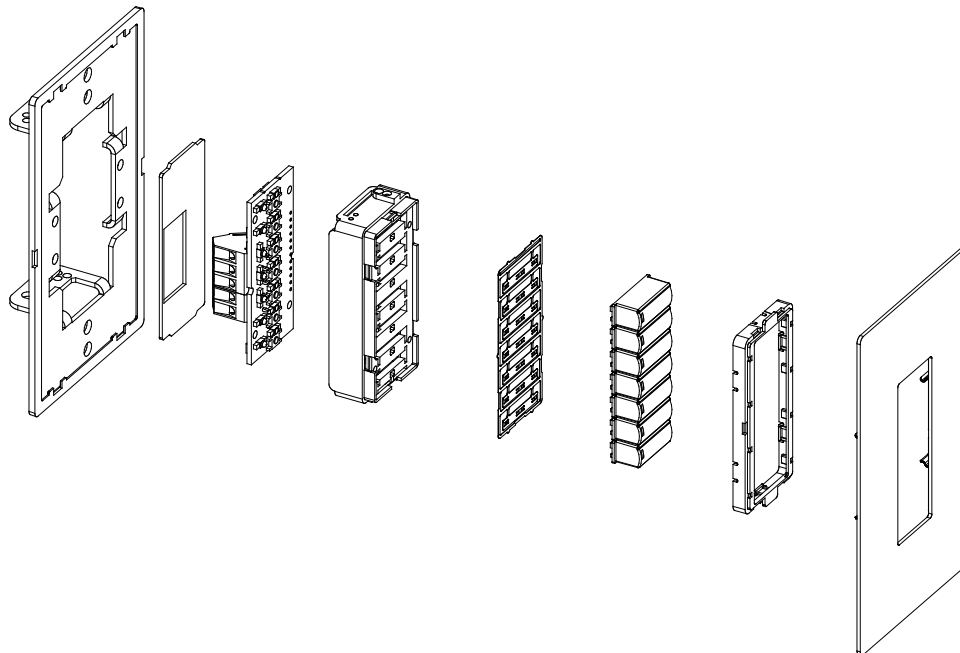

button caps

The button shape offers a generous area for text or symbols, ensuring that the function of each button is clearly discernable from normal viewing distances. Over nineteen standard engraved button caps are available ex-stock. Contact your local Dynalite dealer for details on custom engraving.



Charcoal (CH)



Silver (SL)



IR Receive (IR)

standard panels

Detailed below are catalogue numbers for the standard panel configurations, which are supplied complete with blue LED status indicators, and charcoal grey buttons. Note that the option code must be stipulated for the respective button and LED colour required.

Grid Plate	Configurable Panel
1 Button	DRP91A-CSS
3 Button	DRP93D-CSS
5 Button	DRP95H-CSS
6 Button	DRP96K-CSS
7 Button	DRP97L-CSS
8 Button	DRP98M-CSS

DRP user control panels

panel ordering information

Detailed below are the DRP configuration option product codes. Use these codes to specify your requirements.

DRP95H-WSS-DN

Series	Description
DRP	Australia/US
DRPE	European/UK

Button Colour	Description
W	White
C	Charcoal
S	Silver

Option	Description
IR	IR Receive Button Fitted
J	2 Room Join Keyswitch
J3	3 Room Join Keyswitch
D	Panel Enable Keyswitch
N	Network Socket
F#	Fader Panel with # of faders
GL	Green Status LEDs
RL	Red Status LEDs

Capability	Description
9	9 Series

Button Count	Description
#	Total # of buttons

Cover Finish	Description
SS	Brushed Stainless Steel
WG	White Float Glass
BG	Black Float Glass
CO	Silver Corrugated
CH	Silver Chequerplate
IS	Ivory Processed Stone

Configuration	A	B	C	D	E	F
---------------	---	---	---	---	---	---

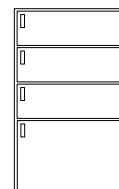
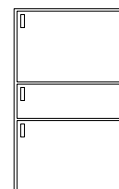
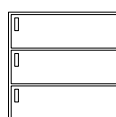
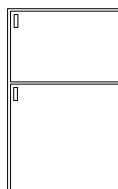
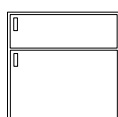
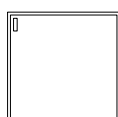

G	H	I	J	K	L	M
---	---	---	---	---	---	---

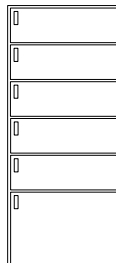

for further information contact: